

FLOODLIGHTS



FLOODLIGHTS

FEATURES

- CAST ALUMINIUM BODY
- ASYMMETRICAL REFLECTOR
- BUILT IN CONTROL GEAR
- 70/150/400 WATT METAL HALIDE
- LOW PROFILE
- IP65

BENEFITS

- LOW GLARE
- EXCELLENT LIGHT CONTROL
- RUGGED CONSTRUCTION
- CORROSION RESISTANT
- ATTRACTIVE FINISH

APPLICATIONS

- STORAGE AREAS
- CAR PARKS
- BUILDING SECURITY
- FACIA LIGHTING
- SCHOOLS
- SHOPPING CENTRES

ASYMER

- 400 WATT SKU 366001

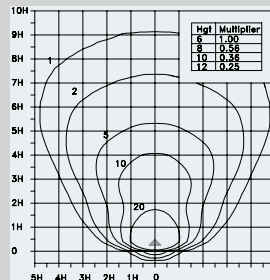

UTILITY 70W

- 70 WATT SKU 366002

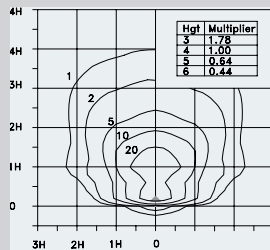

UTILITY 150W

- 150 WATT SKU 366003

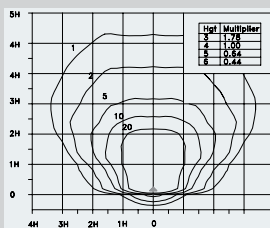

UTILITY 400W

- 400 WATT SKU 366004

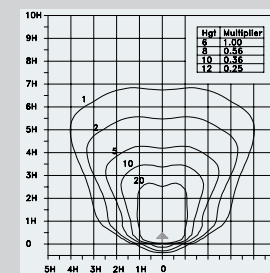

FLOODLIGHTS

FEATURES

- CAST ALUMINIUM BODY
- ASYMMETRICAL REFLECTOR
- BUILT IN CONTROL GEAR
- 70/150/400 WATT METAL HALIDE
- LOW PROFILE
- IP65

BENEFITS

- LOW GLARE
- EXCELLENT LIGHT CONTROL
- RUGGED CONSTRUCTION
- CORROSION RESISTANT
- ATTRACTIVE FINISH

APPLICATIONS

- STORAGE AREAS
- CAR PARKS
- BUILDING SECURITY
- FACIA LIGHTING
- SCHOOLS
- SHOPPING CENTRES

SHIELD

- 150 WATT SKU 366006
- 250 WATT SKU 366007

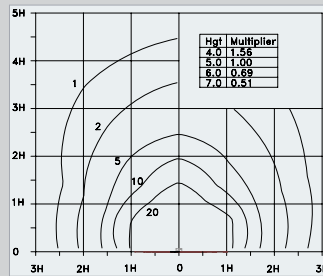

CAVERN

- 70 WATT SKU 365022
- 150 WATT SKU 365023

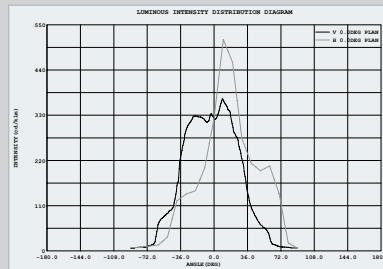

ASYMER FLOODLIGHT



ASYMER

The ASYMER floodlight comprises of a low profile IP65 aluminium body fitted with internal control gear. This fixture is extremely efficient and accurate with control maintained over spill light to avoid light glare and wastage.

The low glare Asymer is angled when mounted to ensure minimal exposure to wind. The fixture is ideal for exterior applications such as schools, car parks, building security and parks.

| SKU | WATTS | LENGTH | WIDTH | HEIGHT | CONT/GEAR | LAMP |
|--------|---------|--------|-------|--------|-----------|------|
| 366001 | 400W MH | 445mm | 375mm | 165mm | ✓ | ✓ |

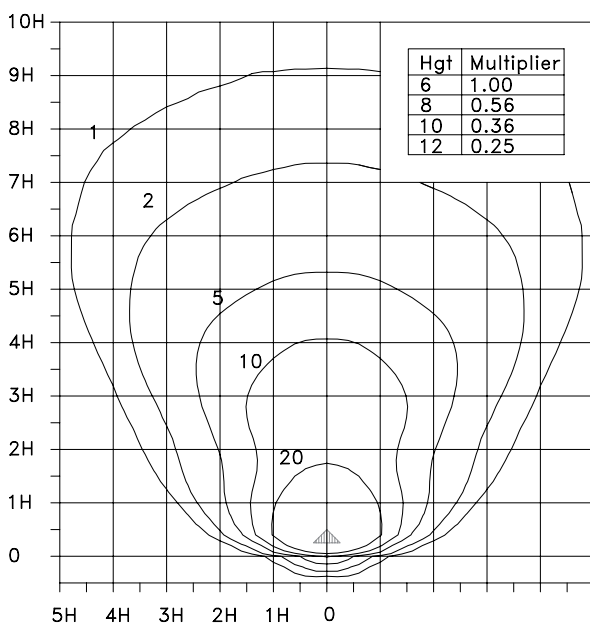

- Mounting Height = 6m
- Elevation Angle = 60°



Light Output Ratio = 66.2%
90% Beam Spread
50% Beam Lumens

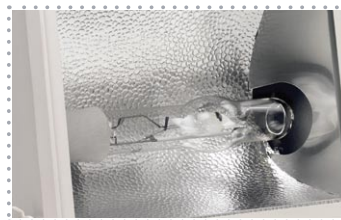

- Photometric data available upon request.
- Values are INITIAL Horizontal Illumination at ground level

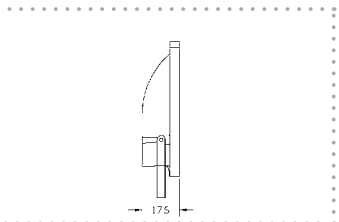
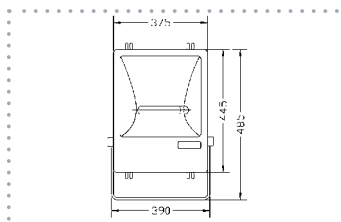

- Above polar curve is for 400 Watt MH output
- Photometric data available at www.beaconlightingcommercial.com.au

UTILITY 70W FLOODLIGHT



UTILITY 70W

The UTILITY 70W combines the rugged construction of cast IP65 aluminium body with an asymmetric reflector to provide optimum light output.

The Utility is fitted with internal control gear as standard and requires low maintenance making it an ideal fixture for multiple use areas such as car parks, shopping centres, schools and building security lighting.

| SKU | WATTS | LENGTH | WIDTH | HEIGHT | CONT/GEAR | LAMP |
|--------|--------|--------|-------|--------|-----------|------|
| 366002 | 70W MH | 290mm | 220mm | 190mm | ✓ | ✓ |

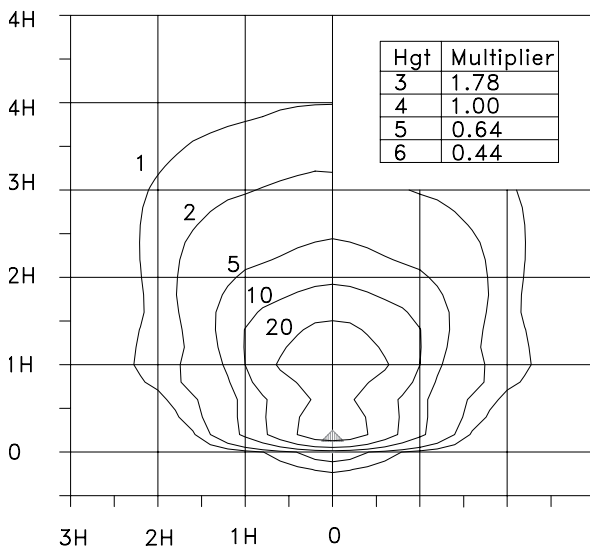

Light Output Ratio = 57.2%
90% Beam Spread
50% Beam Lumens

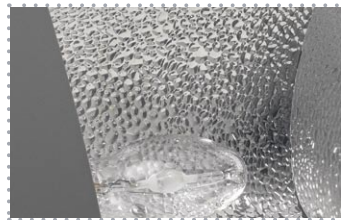

- Photometric data available upon request.
- Values are INITIAL Horizontal Illumination at ground level

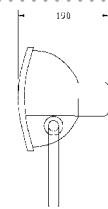
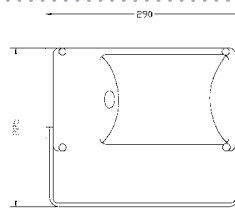

- Mounting Height = 4m
- Elevation Angle = 60°

- Above polar curve is for 70 Watt MH output
- Photometric data available at www.beaconlightingcommercial.com.au

UTILITY 150W FLOODLIGHT



UTILITY 150W

The UTILITY 150W combines the rugged construction of cast IP65 aluminium body with an asymmetric reflector to provide optimum light output.

The Utility is fitted with internal control gear as standard and requires low maintenance making it an ideal fixture for multiple use areas such as car parks, shopping centres, schools and building security lighting.

| SKU | WATTS | LENGTH | WIDTH | HEIGHT | CONT/GEAR | LAMP |
|--------|---------|--------|-------|--------|-----------|------|
| 366003 | 150W MH | 290mm | 220mm | 190mm | ✓ | ✓ |

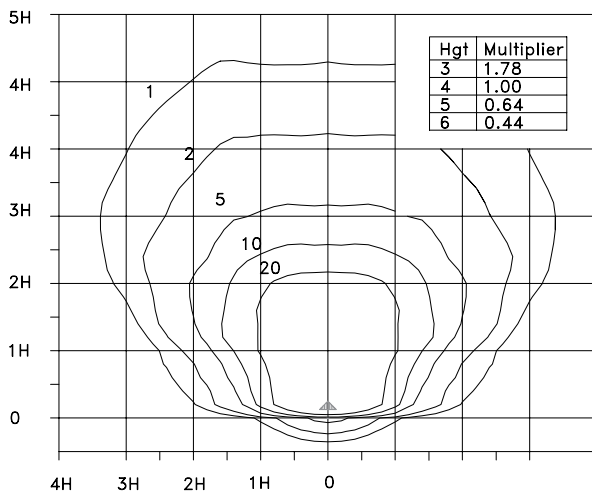

Light Output Ratio = 52.7%
90% Beam Spread
50% Beam Lumens

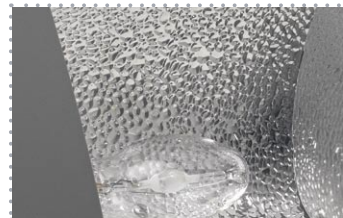

- Photometric data available upon request.
- Values are INITIAL Horizontal Illumination at ground level

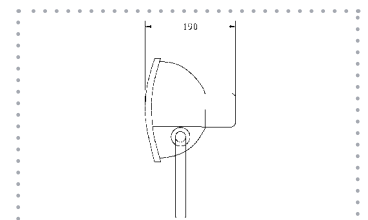
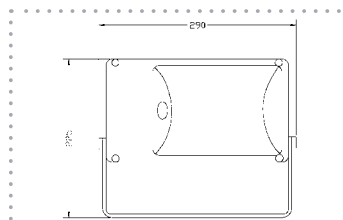

- Mounting Height = 4m
- Elevation Angle = 60°

- Above polar curve is for 150 Watt MH output
- Photometric data available at www.beaconlightingcommercial.com.au

UTILITY 400W FLOODLIGHT



UTILITY 400W

The UTILITY 400W combines the rugged construction of cast IP65 aluminium body with an asymmetric reflector to provide optimum light output.

The Utility is fitted with internal control gear as standard and requires low maintenance making it an ideal fixture for multiple use areas such as car parks, shopping centres, schools and building security lighting.

| SKU | WATTS | LENGTH | WIDTH | HEIGHT | CONT/GEAR | LAMP |
|--------|---------|--------|-------|--------|-----------|------|
| 366004 | 400W MH | 420mm | 330mm | 265mm | ✓ | ✓ |

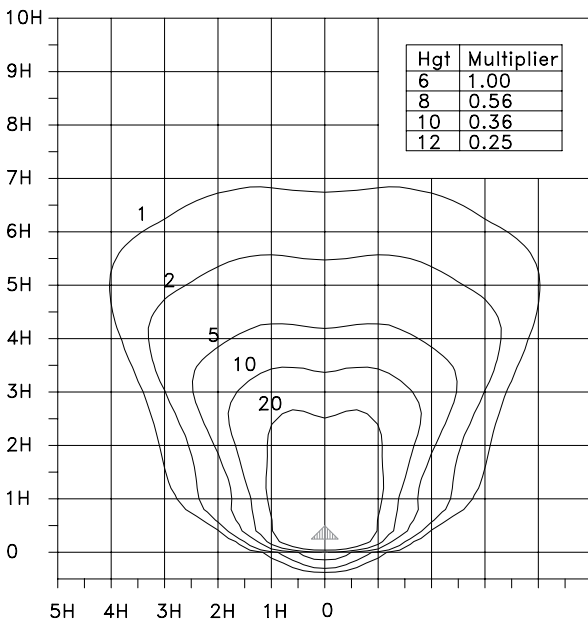

- Mounting Height = 6m
- Elevation Angle = 60°



Light Output Ratio = 53.4%
90% Beam Spread
50% Beam Lumens

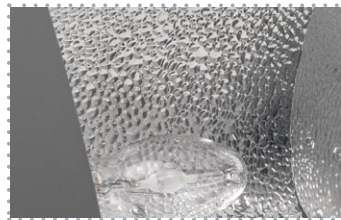

- Photometric data available upon request.
- Values are INITIAL Horizontal Illumination at ground level

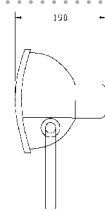
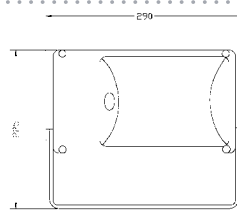

- Above polar curve is for 400 Watt MH output
- Photometric data available at www.beaconlightingcommercial.com.au

SHIELD FLOODLIGHT



SHIELD

The neat and compact SHIELD combines the rugged strength of IP65 construction with a clean architectural finish.

The fixture is fitted with internal control gear as standard and provides an energy efficient lighting solution perfect for perimeter security lighting.

| SKU | WATTS | LENGTH | WIDTH | HEIGHT | CONT/GEAR | LAMP |
|--------|---------|--------|-------|--------|-----------|------|
| 366006 | 150W MH | 365mm | 190mm | 230mm | ✓ | ✓ |
| 366007 | 250W MH | 465mm | 240mm | 230mm | ✓ | ✓ |

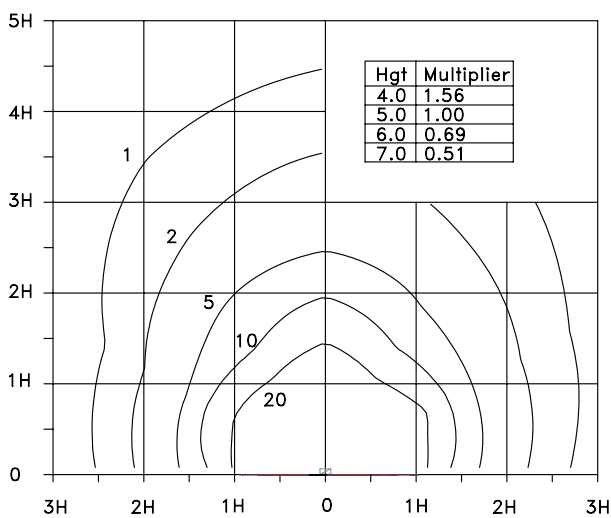

Light Output Ratio = 50.7%
90% Beam Spread
50% Beam Lumens

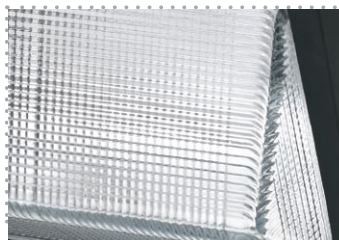

- Photometric data available upon request.
- Charcoal finish cast aluminium
- IP66 wall mounted

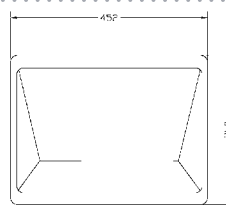

LINE DRAWING FOR 250W

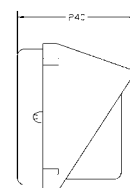

LINE DRAWING FOR 250W

- Mounting Height = 4m
- Values are INITIAL Horizontal Illumination at ground level

- Above polar curve is for 250 Watt MH output
- Photometric data available at www.beaconlightingcommercial.com.au

CAVERN FLOODLIGHT



CAVERN

The CARVERN is a sharp and clean uplighter comprising of metal halide lamps and fitted with internal control gear as standard. The sturdy and rugged construction also includes a IP66 aluminum body.

This fitting is ideal in either interior or exterior uplighting applications such as museums, shopping centres and to highlight areas of interest.

| SKU | WATTS | LENGTH | WIDTH | HEIGHT | CONT/GEAR | LAMP |
|--------|-------------|--------|-------|--------|-----------|------|
| 365022 | 70W R7S MH | 315mm | 200mm | 155mm | ✓ | ✓ |
| 365023 | 150W R7S MH | 315mm | 200mm | 155mm | ✓ | ✓ |

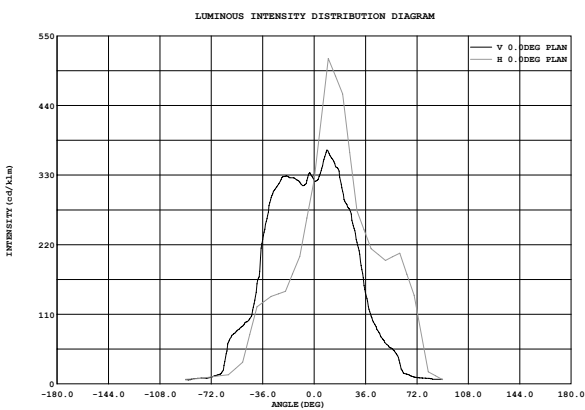

Light Output Ratio = 70%
90% Beam Spread
50% Beam Lumens



- Photometric data available upon request.
- Silver finish cast aluminium
- IP66 wall mounted

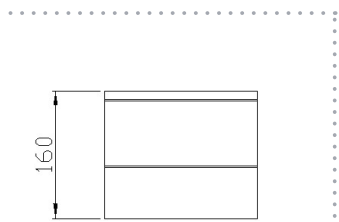
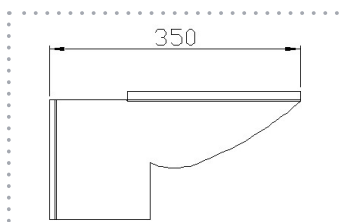

- Above polar curve is for 150 Watt MH output
- Photometric data available at www.beaconlightingcommercial.com.au